

Component No.	Tektronix Part No.	Serial/Assembly No. Effective	Discont	Name & Description	Mfr. Code	Mfr. Part No.
A1	118-3441-00	8010100	8010399	CIRCUIT BOARD: DIGITIZER (4957 ONLY)	55170	04-0081-003
A1	118-3441-01	8010400		CIRCUIT BOARD: DIGITIZER (4957 ONLY)	80009	118-3441-01
A1C1	290-0536-00			CAP, FXD, ELCTLT: 10UF, 20%, 25V TANTALUM	05397	T3688106M025AS
A1C2	290-0536-00			CAP, FXD, ELCTLT: 10UF, 20%, 25V TANTALUM	05397	T3688106M025AS
A1C3	283-0003-00			CAP, FXD, CER DI: 0.01UF, +80-20%, 150V	59821	0103740Z5UJDCX
A1C4	283-0003-00			CAP, FXD, CER DI: 0.01UF, +80-20%, 150V	59821	0103740Z5UJDCX
A1C5	283-0003-00			CAP, FXD, CER DI: 0.01UF, +80-20%, 150V	59821	0103740Z5UJDCX
A1C6	283-0003-00			CAP, FXD, CER DI: 0.01UF, +80-20%, 150V	59821	0103740Z5UJDCX
A1C7	283-0003-00			CAP, FXD, CER DI: 0.01UF, +80-20%, 150V	59821	0103740Z5UJDCX
A1C8	283-0003-00			CAP, FXD, CER DI: 0.01UF, +80-20%, 150V	59821	0103740Z5UJDCX
A1C9	283-0003-00			CAP, FXD, CER DI: 0.01UF, +80-20%, 150V	59821	0103740Z5UJDCX
A1C10	283-0003-00			CAP, FXD, CER DI: 0.01UF, +80-20%, 150V	59821	0103740Z5UJDCX
A1C11	283-0003-00			CAP, FXD, CER DI: 0.01UF, +80-20%, 150V	59821	0103740Z5UJDCX
A1C12	283-0003-00			CAP, FXD, CER DI: 0.01UF, +80-20%, 150V	59821	0103740Z5UJDCX
A1C13	283-0003-00			CAP, FXD, CER DI: 0.01UF, +80-20%, 150V	59821	0103740Z5UJDCX
A1C14	283-0003-00			CAP, FXD, CER DI: 0.01UF, +80-20%, 150V	59821	0103740Z5UJDCX
A1C15	283-0003-00			CAP, FXD, CER DI: 0.01UF, +80-20%, 150V	59821	0103740Z5UJDCX
A1C16	283-0003-00			CAP, FXD, CER DI: 0.01UF, +80-20%, 150V	59821	0103740Z5UJDCX
A1C17	283-0003-00			CAP, FXD, CER DI: 0.01UF, +80-20%, 150V	59821	0103740Z5UJDCX
A1C18	283-0003-00			CAP, FXD, CER DI: 0.01UF, +80-20%, 150V	59821	0103740Z5UJDCX
A1C19	283-0003-00			CAP, FXD, CER DI: 0.01UF, +80-20%, 150V	59821	0103740Z5UJDCX
A1C20	283-0003-00			CAP, FXD, CER DI: 0.01UF, +80-20%, 150V	59821	0103740Z5UJDCX
A1C21	283-0003-00			CAP, FXD, CER DI: 0.01UF, +80-20%, 150V	59821	0103740Z5UJDCX
A1C22	283-0003-00			CAP, FXD, CER DI: 0.01UF, +80-20%, 150V	59821	0103740Z5UJDCX
A1C23	283-0003-00			CAP, FXD, CER DI: 0.01UF, +80-20%, 150V	59821	0103740Z5UJDCX
A1C24	290-0536-00			CAP, FXD, ELCTLT: 10UF, 20%, 25V TANTALUM	05397	T3688106M025AS
A1C25	290-0536-00			CAP, FXD, ELCTLT: 10UF, 20%, 25V TANTALUM	05397	T3688106M025AS
A1C26	283-0813-00			CAP, FXD, CER DI: 0.039MF, 50V	56289	CKR058X393KM
A1C27	290-0536-00			CAP, FXD, ELCTLT: 10UF, 20%, 25V TANTALUM	05397	T3688106M025AS
A1C28	290-0536-00			CAP, FXD, ELCTLT: 10UF, 20%, 25V TANTALUM	05397	T3688106M025AS
A1C29	283-0111-00			CAP, FXD, CER DI: 0.1UF, 20%, 50V	05397	C330C104MSU1CA
A1C30	290-0536-00			CAP, FXD, ELCTLT: 10UF, 20%, 25V TANTALUM	05397	T3688106M025AS
A1C31	283-0341-00	8010100	8010399	CAP, FXD, CER DI: 0.047UF, 10%, 100V	04222	SR301C473KAA
A1C32	290-0536-00			CAP, FXD, ELCTLT: 10UF, 20%, 25V TANTALUM	05397	T3688106M025AS
A1C33	290-0536-00			CAP, FXD, ELCTLT: 10UF, 20%, 25V TANTALUM	05397	T3688106M025AS
A1C34	283-0111-00			CAP, FXD, CER DI: 0.1UF, 20%, 50V	05397	C330C104MSU1CA
A1C35	290-0536-00			CAP, FXD, ELCTLT: 10UF, 20%, 25V TANTALUM	05397	T3688106M025AS
A1C36	290-0536-00			CAP, FXD, ELCTLT: 10UF, 20%, 25V TANTALUM	05397	T3688106M025AS
A1C37	283-0100-00			CAP, FXD, CER DI: 0.0047UF, 10%, 200V	04222	SR306A472KAA
A1C38	283-0111-00			CAP, FXD, CER DI: 0.1UF, 20%, 50V	05397	C330C104MSU1CA
A1C39	283-0000-00			CAP, FXD, CER DI: 0.001UF, +100-0%, 500V	59860	831-610-Y5U0102P
A1C40	290-0536-00			CAP, FXD, ELCTLT: 10UF, 20%, 25V TANTALUM	05397	T3688106M025AS
A1C41	283-0111-00			CAP, FXD, CER DI: 0.1UF, 20%, 50V	05397	C330C104MSU1CA
A1C42	283-0111-00			CAP, FXD, CER DI: 0.1UF, 20%, 50V	05397	C330C104MSU1CA
A1C43	283-0111-00			CAP, FXD, CER DI: 0.1UF, 20%, 50V	05397	C330C104MSU1CA
A1C44	283-0111-00			CAP, FXD, CER DI: 0.1UF, 20%, 50V	05397	C330C104MSU1CA
A1C45	283-0111-00			CAP, FXD, CER DI: 0.1UF, 20%, 50V	05397	C330C104MSU1CA
A1C46	283-0111-00			CAP, FXD, CER DI: 0.1UF, 20%, 50V	05397	C330C104MSU1CA
A1C47	290-0536-00			CAP, FXD, ELCTLT: 10UF, 20%, 25V TANTALUM	05397	T3688106M025AS
A1C48	290-0536-00			CAP, FXD, ELCTLT: 10UF, 20%, 25V TANTALUM	05397	T3688106M025AS
A1C49	283-0100-00			CAP, FXD, CER DI: 0.0047UF, 10%, 200V	04222	SR306A472KAA
A1C50	283-0111-00	8010400		CAP, FXD, CER DI: 0.1UF, 20%, 50V	05397	C330C104MSU1CA
A1CR3	152-0141-02			SEMICOND DVC, DI: SM, SI, 30V, 150MA, 30V	03508	DA2527 (1M4152)
A1CR4	152-0141-02			SEMICOND DVC, DI: SM, SI, 30V, 150MA, 30V	03508	DA2527 (1M4152)
A1CR5	152-0141-02			SEMICOND DVC, DI: SM, SI, 30V, 150MA, 30V	03508	DA2527 (1M4152)
A1J1	118-3444-00			CONNECTOR: CURSOR	55170	68-1033-001
A1L1	108-1226-00			COIL, RF: 47MH	00213	HEE-47

REPLACEABLE PARTS

Component No.	Tektronix Part No.	Serial/Assembly No. Effective Dscnt	Name & Description	Mfr. Code	Mfr. Part No.
A1L2	108-1226-00		COIL, RF:47MH	00213	NEE-47
A1L3	108-1226-00		COIL, RF:47MH	00213	NEE-47
A1Q1	151-0190-00		TRANSISTOR:NPN, SI, TO-92	80009	151-0190-00
A1Q2	151-0188-00		TRANSISTOR:PMP, SI, TO-92	80009	151-0188-00
A1Q3	151-0190-00		TRANSISTOR:NPN, SI, TO-92	80009	151-0190-00
A1Q4	151-0188-00		TRANSISTOR:PMP, SI, TO-92	80009	151-0188-00
A1Q5	151-0190-00		TRANSISTOR:NPN, SI, TO-92	80009	151-0190-00
A1R2	321-0285-00		RES, FXD, FILM:9.09K OHM, 1%, 0.125M, TC=TO	07716	CEA090900F
A1R3	321-0293-00		RES, FXD, FILM:11.0K OHM, 1%, 0.125M, TC=TO	07716	CEA011001F
A1R4	315-0103-00		RES, FXD, FILM:10K OHM, 5%, 0.25M	19701	5043CX10K00J
A1R5	315-0202-00		RES, FXD, FILM:2K OHM, 5%, 0.25M	57668	NTR25J-E 2K
A1R6	315-0102-00		RES, FXD, FILM:1K OHM, 5%, 0.25M	57668	NTR25JED1K0
A1R7	315-0390-00		RES, FXD, FILM:39 OHM, 5%, 0.25M	57668	NTR25J-E39E0
A1R8	315-0222-00		RES, FXD, FILM:2.2K OHM, 5%, 0.25M	57668	NTR25J-E22K2
A1R9	315-0222-00		RES, FXD, FILM:2.2K OHM, 5%, 0.25M	57668	NTR25J-E22K2
A1R10	315-0222-00	B010100	RES, FXD, FILM:2.2K OHM, 5%, 0.25M	57668	NTR25J-E22K2
A1R22	315-0432-00		RES, FXD, FILM:4.3K OHM, 5%, 0.25M	57668	NTR25J-E43K3
A1R23	315-0103-00		RES, FXD, FILM:10K OHM, 5%, 0.25M	19701	5043CX10K00J
A1R24	315-0103-00		RES, FXD, FILM:10K OHM, 5%, 0.25M	19701	5043CX10K00J
A1R25	315-0103-00		RES, FXD, FILM:10K OHM, 5%, 0.25M	19701	5043CX10K00J
A1R26	315-0101-00		RES, FXD, FILM:100 OHM, 5%, 0.25M	57668	NTR25J-E 100E
A1R27	315-0512-00		RES, FXD, FILM:5.1K OHM, 5%, 0.25M	57668	NTR25J-E05K1
A1R28	315-0303-00	B010100	RES, FXD, FILM:30K OHM, 5%, 0.25M	19701	5043CX30K00J
A1R28	315-0433-00	B010400	RES, FXD, FILM:43K OHM, 5%, 0.25M	19701	5043CX43K00J
A1R29	321-0280-00		RES, FXD, FILM:8.06K OHM, 1%, 0.125M, TC=TO	19701	5033ED8K060F
A1R30	321-0267-00		RES, FXD, FILM:5.90K OHM, 1%, 0.125M, TC=TO	19701	5033ED5K900F
A1R31	315-0511-00		RES, FXD, FILM:510 OHM, 5%, 0.25M	19701	5043CX510R0J
A1R32	315-0511-00	B010100	RES, FXD, FILM:510 OHM, 5%, 0.25M	19701	5043CX510R0J
A1R33	315-0471-00		RES, FXD, FILM:470 OHM, 5%, 0.25M	57668	NTR25J-E470E
A1R34	315-0431-00		RES, FXD, FILM:430 OHM, 5%, 0.25M	19701	5043CX430R0J
A1R35	321-0260-00		RES, FXD, FILM:4.99K OHM, 1%, 0.125M, TC=TO	19701	5033ED4K990F
A1R36	321-0260-00		RES, FXD, FILM:4.99K OHM, 1%, 0.125M, TC=TO	19701	5033ED4K990F
A1R37	321-0400-00	B010100	RES, FXD, FILM:143K OHM, 1%, 0.125M, TC=TO	19701	5043ED143K0F
A1R38	315-0202-00		RES, FXD, FILM:2K OHM, 5%, 0.25M	57668	NTR25J-E 2K
A1R39	315-0202-00		RES, FXD, FILM:2K OHM, 5%, 0.25M	57668	NTR25J-E 2K
A1R40	315-0510-00		RES, FXD, FILM:51 OHM, 5%, 0.25M	19701	5043CX51R00J
A1R41	315-0101-00		RES, FXD, FILM:100 OHM, 5%, 0.25M	57668	NTR25J-E 100E
A1R42	321-0210-00		RES, FXD, FILM:1.50K OHM, 1%, 0.125M, TC=TO	19701	5033ED1K50F
A1R43	315-0223-00		RES, FXD, FILM:22K OHM, 5%, 0.25M	19701	5043CX22K00J92U
A1R44	315-0103-00		RES, FXD, FILM:10K OHM, 5%, 0.25M	19701	5043CX10K00J
A1R45	315-0823-00		RES, FXD, FILM:82K OHM, 5%, 0.25M	57668	NTR25J-E82K
A1R46	321-0210-00		RES, FXD, FILM:1.50K OHM, 1%, 0.125M, TC=TO	19701	5033ED1K50F
A1R47	315-0103-00		RES, FXD, FILM:10K OHM, 5%, 0.25M	19701	5043CX10K00J
A1R48	315-0103-00		RES, FXD, FILM:10K OHM, 5%, 0.25M	19701	5043CX10K00J
A1R49	315-0101-00		RES, FXD, FILM:100 OHM, 5%, 0.25M	57668	NTR25J-E 100E
A1R50	315-0432-00	B010100	RES, FXD, FILM:4.3K OHM, 5%, 0.25M	57668	NTR25J-ED4K3
A1R51	321-0280-00		RES, FXD, FILM:8.06K OHM, 1%, 0.125M, TC=TO	19701	5033ED8K060F
A1R52	315-0101-00		RES, FXD, FILM:100 OHM, 5%, 0.25M	57668	NTR25J-E 100E
A1R53	315-0473-00		RES, FXD, FILM:47K OHM, 5%, 0.25M	57668	NTR25J-E47K0
A1R54	315-0473-00		RES, FXD, FILM:47K OHM, 5%, 0.25M	57668	NTR25J-E47K0
A1R55	315-0101-00		RES, FXD, FILM:100 OHM, 5%, 0.25M	57668	NTR25J-E 100E
A1R56	315-0225-00		RES, FXD, FILM:2.2M OHM, 5%, 0.25M	01121	082255
A1R57	315-0103-00		RES, FXD, FILM:10K OHM, 5%, 0.25M	19701	5043CX10K00J
A1R58	315-0103-00		RES, FXD, FILM:10K OHM, 5%, 0.25M	19701	5043CX10K00J
A1R60	321-0267-00		RES, FXD, FILM:5.90K OHM, 1%, 0.125M, TC=TO	19701	5033ED5K900F
A1R61	315-0512-00		RES, FXD, FILM:5.1K OHM, 5%, 0.25M	57668	NTR25J-ED5K1
A1R62	308-0290-00	B010100	RES, FXD, FILM:8 OHM, 5%, 5M	00213	125058-8-5
A1R63	315-0562-00		RES, FXD, FILM:5.6K OHM, 5%, 0.25M	57668	NTR25J-ED5K6
A1R64	315-0431-00		RES, FXD, FILM:430 OHM, 5%, 0.25M	19701	5043CX430R0J

Component No.	Tektronix Part No.	Serial/Assembly No. Effective	Discont	Name & Description	Mfr. Code	Mfr. Part No.
A1R65	307-0057-00			RES,FXD,CMPSN:5.1 OHM,5%,0.5M	01121	EB51G5
A1R66	315-0102-00	B010400		RES,FXD,FILM:1K OHM,5%,0.25M	57668	NTR25JE01K0
A1R67	315-0433-00	B010400		RES,FXD,FILM:43K OHM,5%,0.25M	19701	5043CX43K00J
A1RP1	307-0475-00			RES NTKK,FXD,FI:10K OHM,(15)RES,DIP	03888	PD16L 10KGB
A1VR1	156-0277-01			MICROCKT,LINEAR:POSITIVE VOLTAGE REGULATOR	04713	MC7805CTD
A1Y1	158-0282-00			XTAL UNIT,QTZ:7.3728MHZ	71034	BR2M 7.3728
A1Z1	156-0513-02			MICROCKT,DGTL:CMOS,ANALOG MULTIPLEXER/DEM	02735	CD40518FX
A1Z2	156-0513-02			MICROCKT,DGTL:CMOS,ANALOG MULTIPLEXER/DEM	02735	CD40518FX
A1Z3	156-0513-02			MICROCKT,DGTL:CMOS,ANALOG MULTIPLEXER/DEM	02735	CD40518FX
A1Z4	156-0513-02			MICROCKT,DGTL:CMOS,ANALOG MULTIPLEXER/DEM	02735	CD40518FX
A1Z5	156-0513-02			MICROCKT,DGTL:CMOS,ANALOG MULTIPLEXER/DEM	02735	CD40518FX
A1Z6	156-0513-02			MICROCKT,DGTL:CMOS,ANALOG MULTIPLEXER/DEM	02735	CD40518FX
A1Z7	156-0513-02			MICROCKT,DGTL:CMOS,ANALOG MULTIPLEXER/DEM	02735	CD40518FX
A1Z8	156-2117-00			MICROCKT,DGTL:CMOS,4 TO 16 LINE DECODER/DEM ULTIMPLEXER	27014	MM74C154V
A1Z9	156-0645-02	B010100	B010399	MICROCKT,DGTL:HEX INV ST NAND GATES	04713	SN74LS14NDS
A1Z9	156-0385-02	B010400		MICROCKT,DGTL:HEX INVERTER	07263	74LS04PCQR
A1Z10	118-3443-00			MICROCKT,DGTL:PROGRAMMED	55170	52-5030-003
A1Z11	156-1172-01			MICROCKT,DGTL:DUAL 4 BIT BIN CNTR	01295	SN74LS393MP3
A1Z12	156-2118-00			MICROCKT,DGTL:DUAL J-K MASTER SLAVE FLIP-FL OP W/CLEAR,SCRN	27014	SN74LS107AN
A1Z13	156-0879-01			MICROCKT,DGTL:QUAD LINE DRIVER	04713	MC1488LD
A1Z14	156-1126-01			MICROCKT,LINEAR:VOLTAGE COMPARATOR,SELECTED	01295	LM311JG4
A1Z15	156-0853-02			MICROCKT,LINEAR:DUAL OPNL AMP,CHK	04713	LM358J
A1Z16	156-2119-00			MICROCKT,DGTL:OPERATIONAL MULTIPLIER	52063	XR-2208CP
A1Z17	156-1191-01			MICROCKT,LINEAR:DUAL BI-FET OP-AMP,8 DIP	80009	156-1191-01
A1Z18	156-0513-02			MICROCKT,DGTL:CMOS,ANALOG MULTIPLEXER/DEM	02735	CD40518FX
A1Z19	156-0513-02			MICROCKT,DGTL:CMOS,ANALOG MULTIPLEXER/DEM	02735	CD40518FX
A1Z20	156-0513-02			MICROCKT,DGTL:CMOS,ANALOG MULTIPLEXER/DEM	02735	CD40518FX
A1Z21	156-0513-02			MICROCKT,DGTL:CMOS,ANALOG MULTIPLEXER/DEM	02735	CD40518FX
A1Z22	156-0513-02			MICROCKT,DGTL:CMOS,ANALOG MULTIPLEXER/DEM	02735	CD40518FX
A1Z23	156-0513-02			MICROCKT,DGTL:CMOS,ANALOG MULTIPLEXER/DEM	02735	CD40518FX
A1Z24	156-0513-02			MICROCKT,DGTL:CMOS,ANALOG MULTIPLEXER/DEM	02735	CD40518FX
A1Z25	156-1191-01			MICROCKT,LINEAR:DUAL BI-FET OP-AMP,8 DIP	80009	156-1191-01

Fig. & Index No.	Tektronix Part No.	Serial/Assembly No.		Qty	12345 Name & Description	Mfr.	
		Effective	Dscont			Code	Mfr. Part No.
1-1	118-3440-00			4	FOOT, CABINET:	55170	27-0062-001
-2	118-3439-00			2	SUPPORT, FOOT: TABLET	55170	27-0056-001
-3	118-3437-00			1	SUPPORT, SLIDE: TABLET (ATTACHING PARTS)	55170	27-0054-001
-4	118-3438-00			1	BRACKET, SUPPORT: SLIDE (END ATTACHING PARTS)	55170	27-0055-001
-5	118-3435-00			1	COVER, BOTTOM: TABLET (ATTACHING PARTS)	55170	27-0053-001
-6	213-0119-00			4	SCREEN, TPG, TF: 4-24 X 0.375, TYPE B, PNH, STL (END ATTACHING PARTS)	83385	ORDER BY DESCR
-7	118-3441-00 3441-00			1	CIRCUIT BOARD: DIGITIZER	55170	04-0081-0031
-8	136-0743-00			1	.SKT, PL-IN ELEK: MICROCKT, 24 PIN, LDM PROFILE	00779	640361-1
-9	136-0757-00			1	.SKT, PL-IN ELEK: MICROCKT, 40 DIP	09922	01L840P-108
-10	131-0993-00			2	.BUS, CONDUCTOR: SHUNT ASSEMBLY, BLACK	22526	65474-005
-11	118-3442-00			1	.CA ASSY, SP, ELEC: 25 CONN (ATTACHING PARTS)	55170	05-0130-001
-12	343-0549-00			1	.STRAP, TIEDOWN, E: 0.091 M X 4.0 L, ZYTEL (END ATTACHING PARTS)	06383	PLT1M
-13	-----			1	.MICROCKT, LINEAR: POSITIVE VOLTAGE REGULATOR (SEE VR1 REPL) (ATTACHING PARTS)		
-14	211-0012-00			1	.SCREEN, MACHINE: 4-40 X 0.375, PNH, STL	TK0435	ORDER BY DESCR
-15	342-0563-00			1	.INSULATOR, PLATE: TRANSISTOR	18565	69-11-8805-1674
-16	210-0406-00			1	.NUT, PLAIN, HEX: 4-40 X 0.188, BRS CD PL	73743	12161-50
-17	210-0004-00			1	.WASHER, LOCK: #4 INTL, 0.015 THK, STL (END ATTACHING PARTS)	77900	1204-00-00-0541C
-18	118-3436-00			1	COVER, TOP: TABLET	55170	27-0052-001
-19	119-1775-00			1	CURSOR: PUCK & BUTTON	80009	119-1775-00
	119-1775-01			1	CURSOR: PUCK & BUTTON	80009	119-1775-01
-20	118-3434-00			1	.PAD: FELT FOR CURSOR	80009	118-3434-00
-21	118-3446-0C			1	.COMPONENT KIT: PUSHBUTTON SWITCH	80009	118-3446-00
	118-3446-01			1	.COMPONENT KIT: PUSH BUTTON SWITCH	80009	118-3446-01
-22	119-1748-00			1	POWER SUPPLY: 115V PLUG IN (STANDARD)	80009	119-1748-00

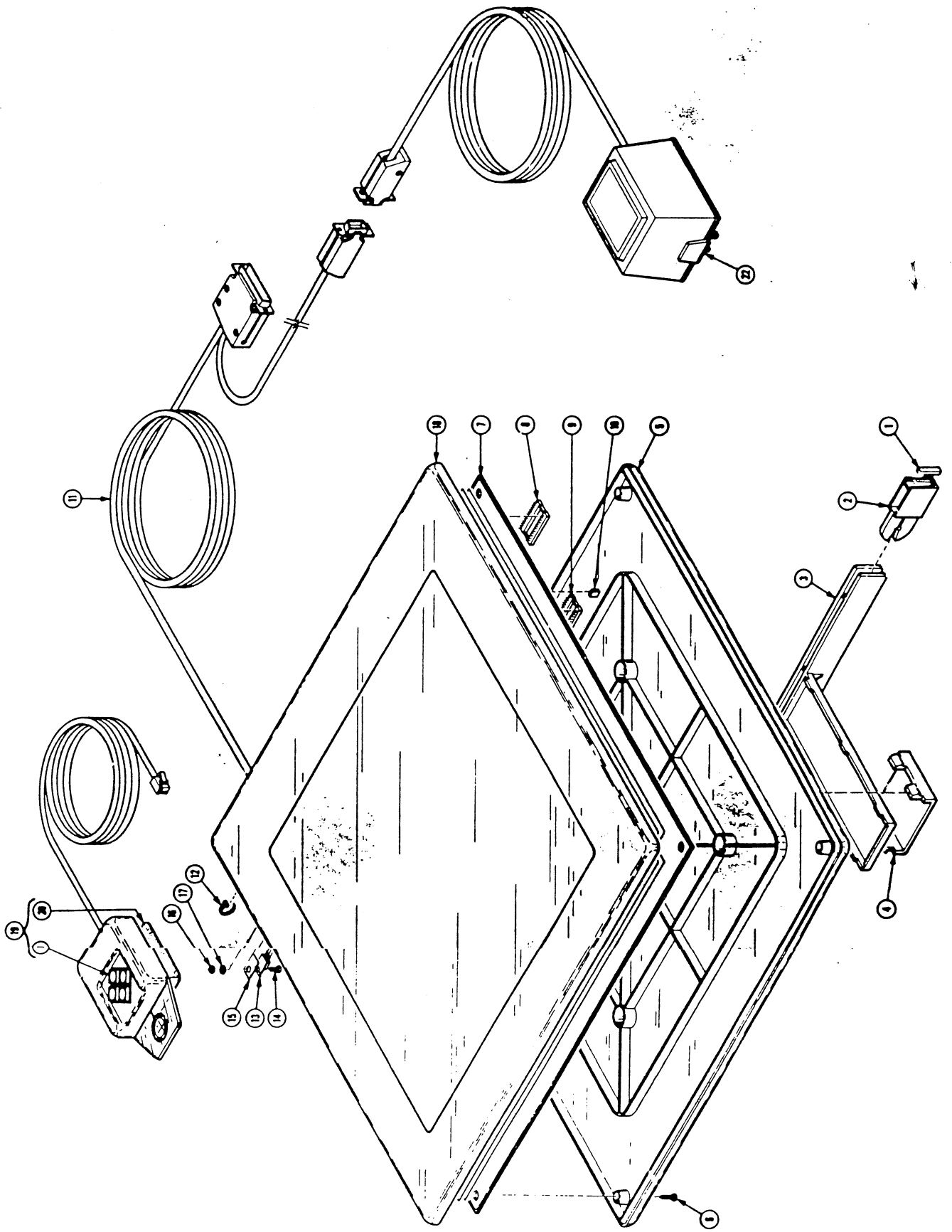

REPLACEABLE PARTS

Fig. & Index No.	Tektronix Part No.	Serial/Assembly No. Effective Dscont	Qty	12345 Name & Description	Mfr. Code	Mfr. Part No.
2-1	118-5963-00		1	COVER,BOTTOM: (ATTACHING PARTS)	55170	03-0272
-2	118-6094-00		1	HARDWARE KIT: (END ATTACHING PARTS)	80009	118-6094-00
-3	118-5964-00		1	CIRCUIT BD ASSY:	55170	04-0127-013
-4	118-5965-00		1	SHIELD,ELEC:	55170	03-0262-001
-5	118-5962-00		1	COVER, TOP:	55170	03-0252-002
-6	012-1193-00		1	CABLE,INTCOM:6.0 L	80009	012-1193-00
-7	119-1775-01		1	CURSOR:PUSK 4 BUTTON	80009	119-1775-01
-8	118-3434-00		1	.PAD:FELT FOR CURSOR	80009	118-3434-00
-9	118-3446-01		1	.COMPONENT KIT:PUSH BUTTON SWITCH	80009	118-3446-01
-10	119-1748-00		1	POWER SUPPLY:115V PLUG IN (STANDARD POWER UNIT)	80009	119-1748-00

